



FRENCH CASEMENT WINDOWS



D12.12 SALTO BOLTS

01.06.2017



SALTO BOLTS

CONTENTS

1. Bolt n° 4408-3	D12.12.03
1.1. General characteristics	D12.12.03
1.2. Bolt sets	D12.12.04
2. Bolt n° 4408-2A	D12.12.05
3. Bolt n° 4404-4	D12.12.06
4. Hinges	D12.12.07
5. Ordering tables	D12.12.08
6. General information	D12.12.09



1. Bolt n° 4408-3

1.1. General characteristics

- The bolt n° 4408-3 is used in the second vent of a double side hung open in window without mullion, in combination with side hung open in windows or turn-tilt windows.
- The bolt can not be used in combination with tilt-turn windows.
- Available as left hand or as right hand bolt.
- The bolt is available in 3 types depending on the shape of the groove, making the length of the fixing screws variable (see drawing below):
 - 4408-3R-6 or 4408-3L-6
 - 4408-3R-12 or 4408-3L-12
 - 4408-3R-16 or 4408-3L-16
- The bolt incorporates the wedges for the locking of the main vent.
- All parts are made of non-corroding material.
- Size range:
 - vent width: max. 1200 mm
 - vent height: 850-2400 mm
 - vent weight: max. 90 kg

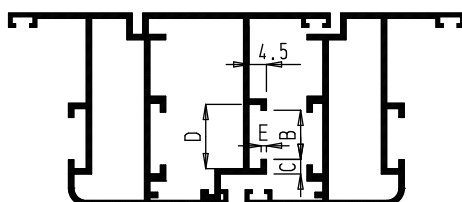

4408-3R-6
or
4408-3L-6

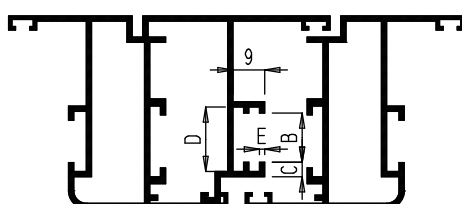

4408-3R-12
or
4408-3L-12

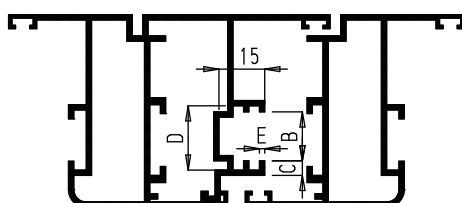

4408-3R-16
or
4408-3L-16

B (mm)	C (mm)	D (mm)	E (mm)
13.8	4.2	18	1.5
14.1	4.2	18.5	2.5



SALTO BOLTS

1.2. Bolt sets

Right hand bolt

Left hand bolt

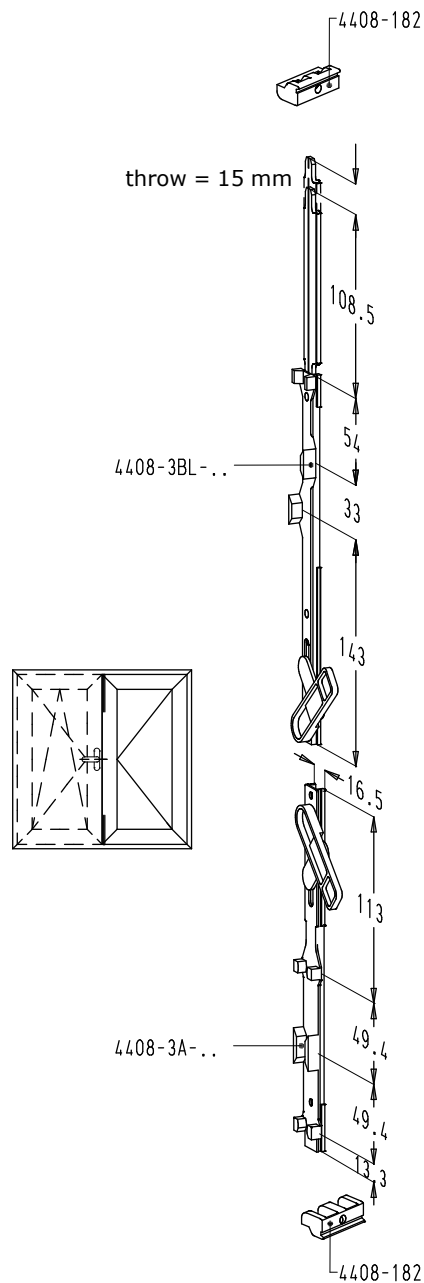
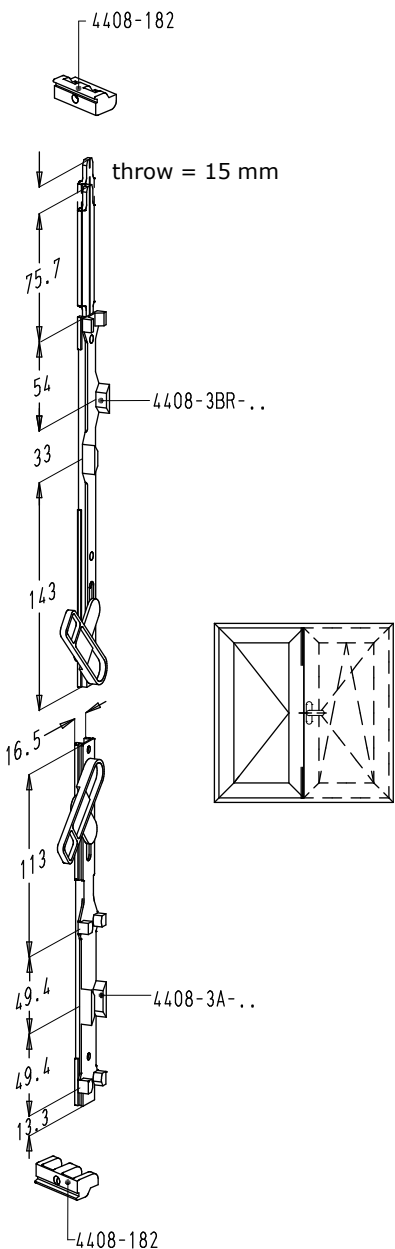

4408-3L-..		
2	4408-182	wedge
1	4408-3BL-..	top bolt
1	4408-3A-..	bottom bolt

4408-3R-..		
2	4408-182	wedge
1	4408-3BR-..	top bolt
1	4408-3A-..	bottom bolt



2. Bolt n° 4408-2A

- The bolt n° 4408-2A is used in the second vent of a double side hung open in window without mullion, in combination with side hung open in windows, turn-tilt windows or tilt-turn windows.
- Suitable for a 14-18 mm double groove.
- The plastic operating piece is mounted into the upper groove, while the aluminium bolt is mounted in the lower groove.
- The bolts are non-handed.
- All parts are made of non-corroding materials.
- Size range:
 - vent width: max. 1200 mm
 - vent height: 850-2400 mm
 - vent weight: max. 90 kg

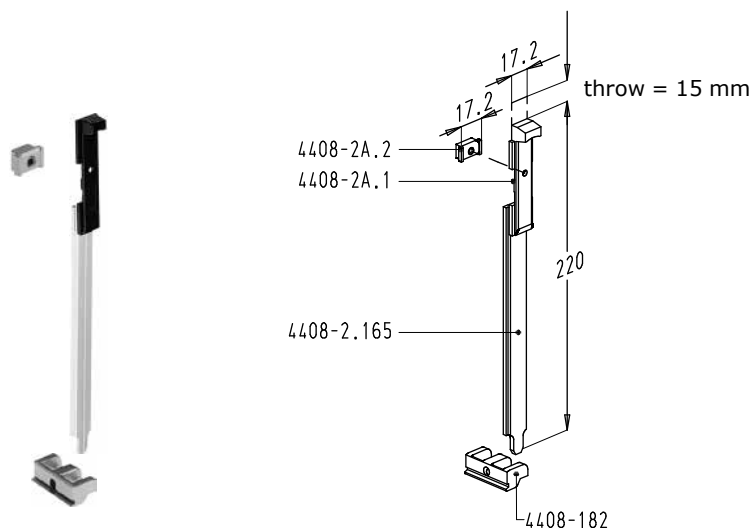
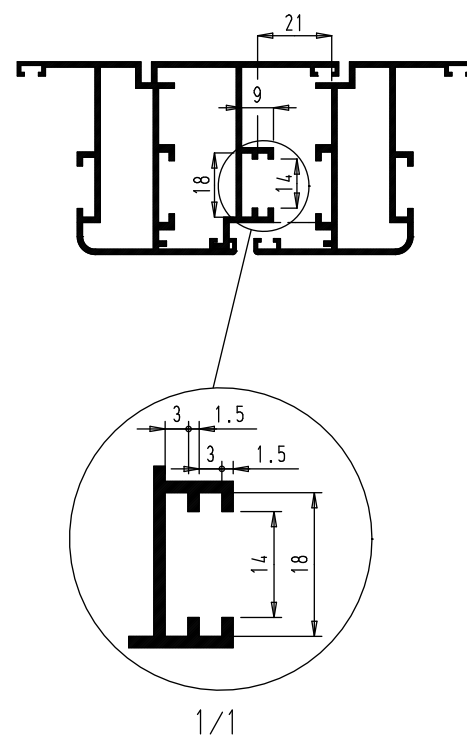
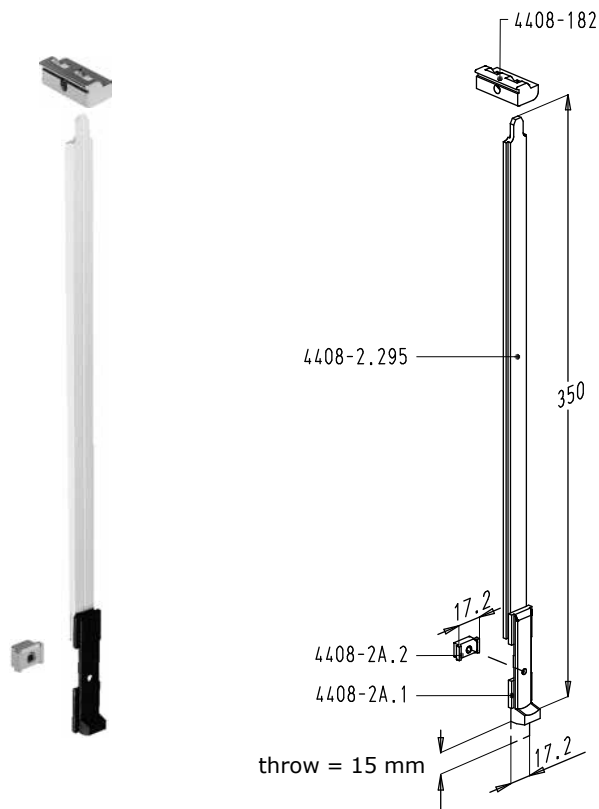
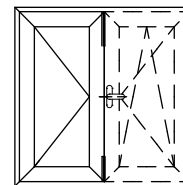

4408-2A		
2	4408-2A.1	operating knob
2	4408-2A.2	blocking piece
2	M5x6	screw
1	4408-2.165	bottom bolt
1	4408-2.295	top bolt
2	4408-182	wedge



SALTO BOLTS

3. Bolt n° 4404-4

- The bolt n° 4404-4 is used in the second vent of a double side hung open in window without mullion, in combination with side hung open in windows, turn-tilt windows or tilt-turn windows.
- Suitable for a 10-15 mm double groove.
- The plastic operating knob is mounted into the upper groove, while the stainless steel bolt is mounted in the lower groove.
- The bolts are non-handed by turning the stainless steel bolts.
- All parts are made of non-corroding materials.
- Size range:
 - vent width: max. 1200 mm
 - vent height: 850-2400 mm
 - vent weight: max. 90 kg

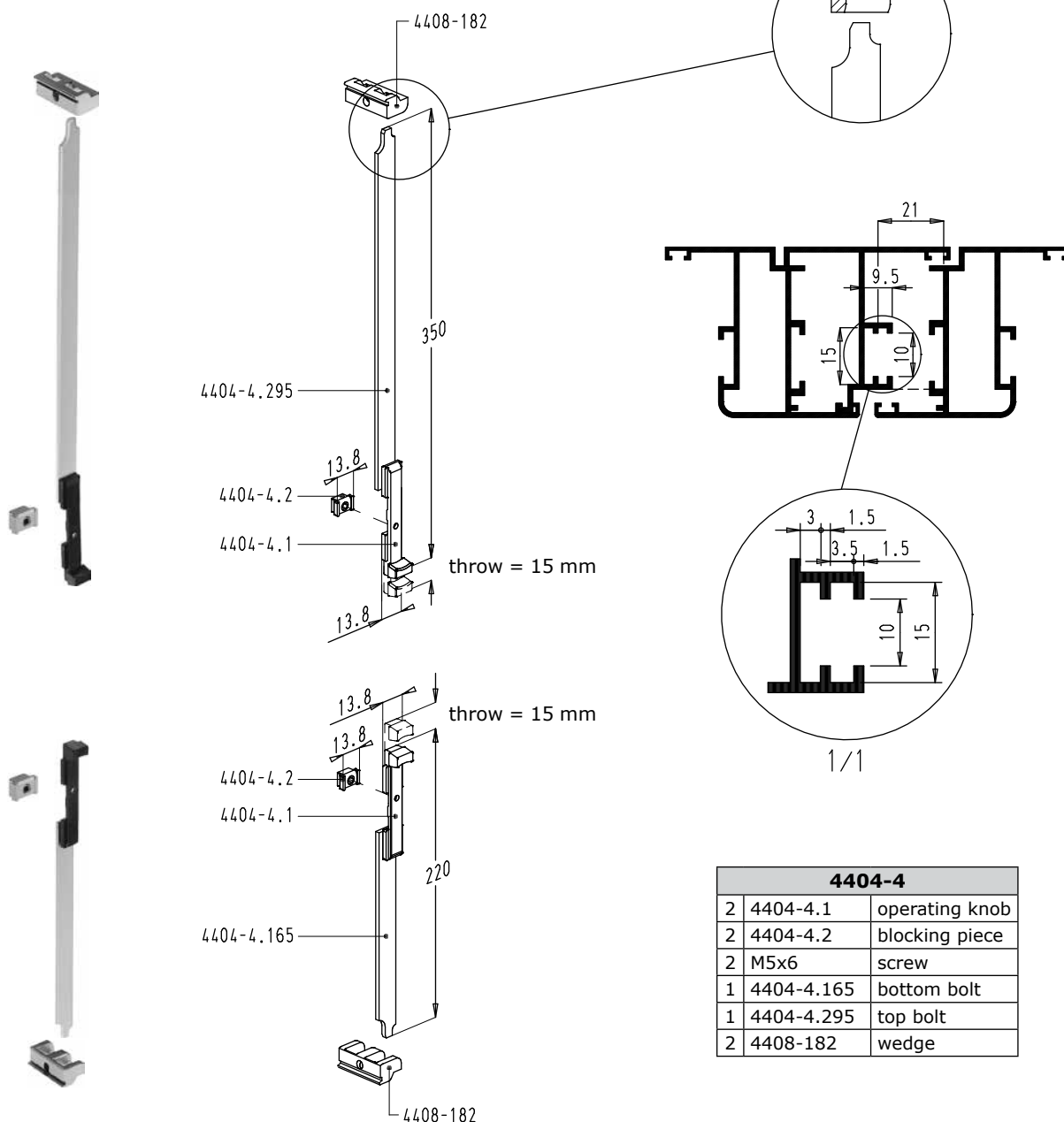
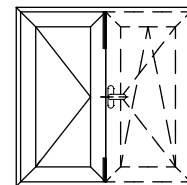

4404-4		
2	4404-4.1	operating knob
2	4404-4.2	blocking piece
2	M5x6	screw
1	4404-4.165	bottom bolt
1	4404-4.295	top bolt
2	4408-182	wedge



4. Hinges

- The hinges are the same shape as the turn-tilt hinges. Both turn-tilt windows and side hung open in windows can be placed next to one another with the advantage of having the same appearance.
- Finish of all hinges: aluminium anodised or polyester powder coated (more than 450 RAL colours).

Chrono bottom hinge n° 26140-760

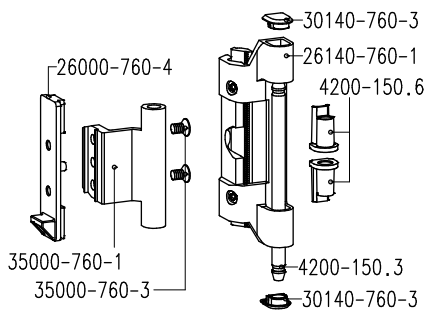

max. vent weight : 90 kg
max. vent width : 1400 mm

Order code	26140-760	26140-750
Fh=max. 1200 mm	1 hinge +	1 hinge
Fh=1200-1800 mm		2 hinges
Fh=1800-2400 mm		3 hinges

Chrono top hinge n° 26140-750

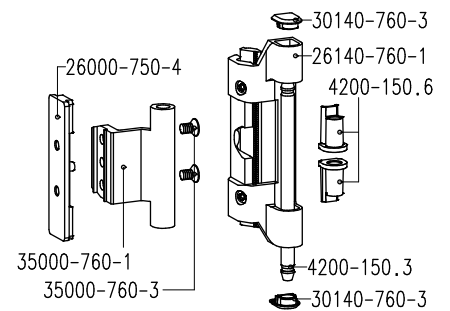

Two part hinge n° 4208-220 and -221

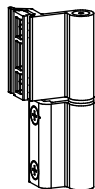

max. 75 kg
max. 1000 mm

vent weight
vent width

max. 80 kg
max. 1200 mm

Order code	4208-220	4208-221	4208-320	4208-321
	G	4.5	5	4.5
Fh=max. 1200 mm	2 hinges			
Fh=1200-1800 mm	3 hinges			
Fh=1800-2400 mm	4 hinges			

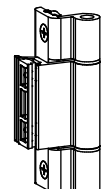

Three part hinge n° 4208-320 and -321

Hinge wedge n° 4208-123

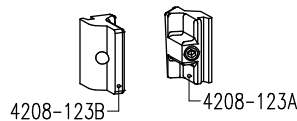

Overview

G (mm)	T	U	V	W	X
4.5	4208-220	4208-320	26140-760	26140-750	4208-123
5	4208-221	4208-321			



SALTO BOLTS

5. Ordering table

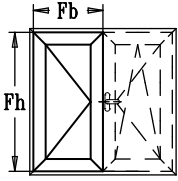
	Fb < 1200		
	4408-3-..	4408-2	4404-4
Fh = 850-1200	4408-3R-6 or 12 or 16 or 4408-3L-6 or 12 or 16 + 2x T or + 2x U or + 1x V + 1x W	4408-2	4404-4
Fh = 1200-1800	4408-3R-6 or 12 or 16 or 4408-3L-6 or 12 or 16 + 3x T or + 2x T + 1x X or + 3x U or + 2x U + 1x X or + 1x V + 2x W or + 1x V + 1x W + 1x X	4408-2	4404-4
Fh = 1800-2400	4408-3R-6 or 12 or 16 or 4408-3L-6 or 12 or 16 + 4x T or + 2x T + 2x X or + 4x U or + 2x U + 2x X or + 1x V + 3x W or + 1x V + 1x W + 2x X	4408-2	4404-4



6. General information

- The systems for french casement windows are made of non-corroding materials. The set should not be installed in corrosive atmospheres.
- Sobinco cannot be held responsible for the malfunctioning of the systems if any non-Sobinco parts are used.
- Surface treatment of vent and frame must take place before assembly of the set, as this will affect the working of the gear.
- Glazing must be in accordance with national standards.
- The window and gear should be kept clean and lubricated in accordance with our maintenance instructions (copy available on request).

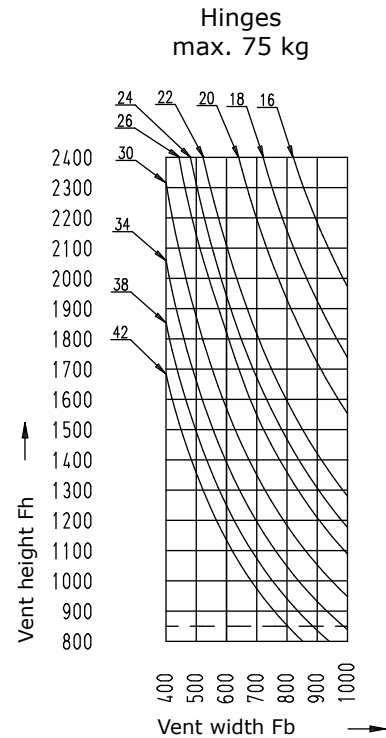

**Bolts n° 4408-3
n° 4408-2A
n° 4404-4**

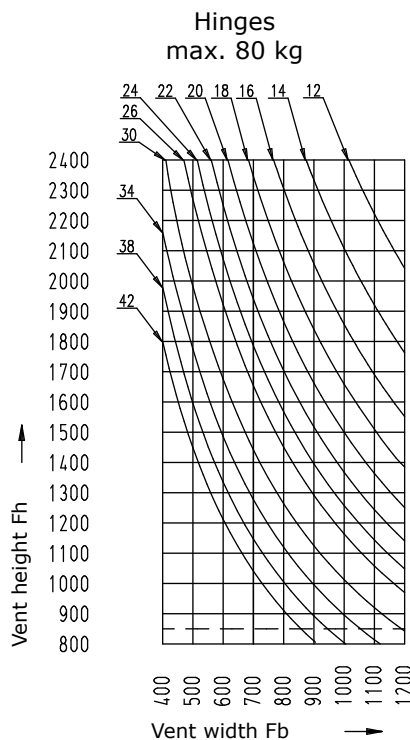

Glass thickness without gap	
mm	kg/m ²
10	25
12	30
14	35
16	40
18	45
20	50
22	55
24	60
26	65
28	70
30	75
32	80
34	85
36	90
38	95
40	100
42	105

